

2021

PRODUCT GUIDE

SHEERVUEW

HORIZONTAL SHEER SHADE

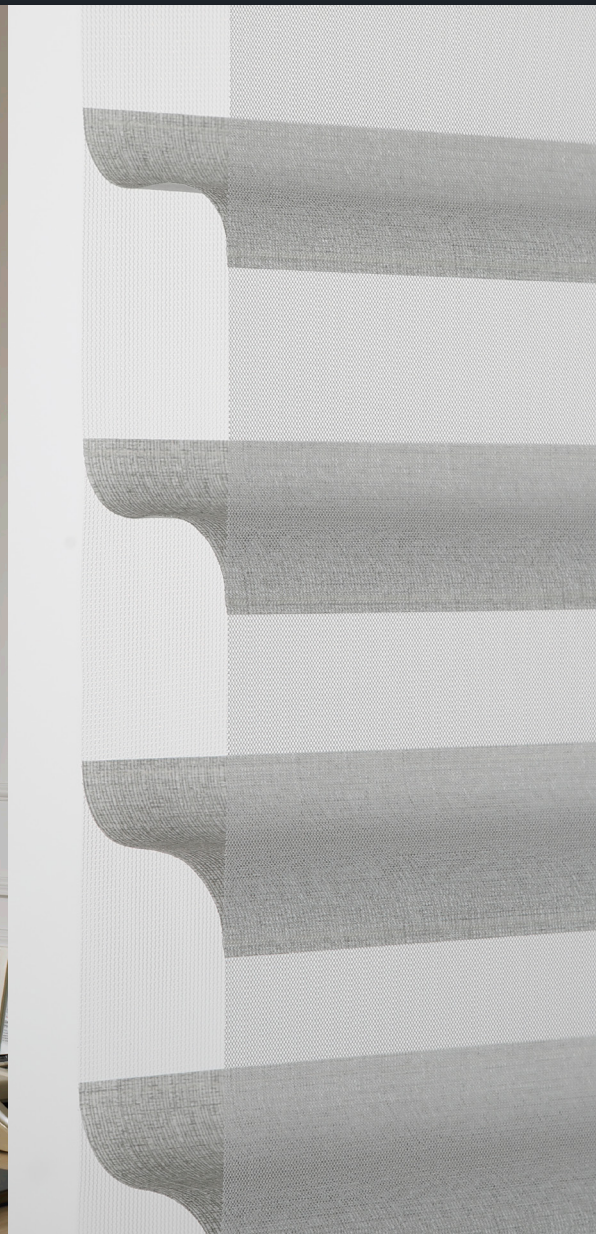

CONGRATULATIONS ON BECOMING A SHEERVIEW SHADE DEALER

TABLE OF CONTENTS

SHEERVIEW SHADE FEATURES	1
AVAILABLE COLORS	2 - 4
PRODUCT DIAGRAMS	5 - 7
HEADRAIL AND BOTTOM-RAIL DETAILS	8
MOTORIZED WAND / REMOTE CONTROL	9
CHILD SAFETY INFORMATION	10
LIGHT FILTERING	11 - 15
ROOM DARKENING	16 - 17
MEASURING	18 - 19
PRODUCT SPECIFICATIONS AND OPERATION	20
E-SERIES PROGRAMMING INFORMATION	21
MANUFACTURES TERMS AND CONDITIONS	22
WARRANTY	23
THE IMPORTANCE OF ORDERING CORRECTLY FROM THE MANUFACTURER	24
ORDER FORM	

SHEERVIEW SHADE FEATURES



- A window shading of unique beauty and performance for the finishing touch to your window and room.
- Horizontal fabric vanes float between two layers of soft, knitted sheers to enlighten your view.
- New vane fabrics feature a softer look for your windows.
- Available in widths up to 108" (Woven Fabric) and 116" (Non-Woven Fabric), and drops to lengths of 144" to provide visual elegance to the widest of windows.
- Vanes glide from open to closed to the out of sight position with elegant hardware.
- The Sheerview continuous cord-loop system provides distinctly different variations of vane positions for numerous combinations of privacy, view and light control.
- An adjustable weight system hidden in the bottom-rail allows for the proper on-the-spot adjustment for a balanced appearance in the window.
- Color coordinated, fabric wrapped headrail styles offer you a sophisticated look.
- All Inside Mounted (IB) Shades will have a light gap on the left and right side. The side with the installed Clutch and Cord-Loop will have a slightly larger light gap.
- Easy to install hardware and brackets allows for effortless installations and easy removal for cleaning.
- Sheerview Shades can be ultrasonically or traditionally cleaned to stay bright and beautiful.
- Limited Lifetime Warranty as a commitment to your satisfaction.

AVAILABLE COLORS *SOLID AND PRINTED TONES*

50mm = 2" VANES | 65mm = 2.5" VANES | 70mm = 3" VANES | D = ROOM DARKENING VANE - COLOR SUFFIX
KN = WOVEN SHEER VANE (★)

PRINTED TONES



HEATHER
S65BN311



BLOSSOM
S65BN206



BLUSH
S65BN312

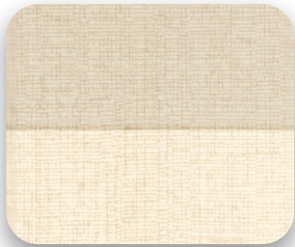

BEIGE
S65BN322



WATERFALL
S65BN627



GRANITE
S65BN823

SOLID TONES



BRIGHT WHITE
S50PN100 / S70PN100
S50PN100D / S70PN100D



ALABASTER
S50PN112 / S70PN112



WINTER WHITE
S50KN113★ / S70KN113★
S50PN113 / S70PN113



LUNA
S70PN126



BEIGE
S50KN322★ / S70KN322★
S50PN322 / S70PN322
S50PN322D / S70PN322D



BLOSSOM
S50KN206★ / S70KN206★
S50PN206 / S70PN206

AVAILABLE COLORS *SOLID TONES*

50mm = 2" VANES | 65mm = 2.5" VANES | 70mm = 3" VANES

D = ROOM DARKENING VANE - COLOR SUFFIX
KN = WOVEN SHEER VANE (★)



ROMANCE
S70PN323



LINEN
S50KN125* / S70KN125*
S50PN125D / S70PN125D



COASTAL PLAIN
S70PN503



CELADON
S70PN517



SESAME
S50PN302 / S70PN302



PLANK
S70PN371



JAVA
S50KN378* / S70KN378*
S50PN378 / S70PN378
S50PN378D / S70PN378D



BRICK
S70PN334D



GRANITE
S50KN823* / S70KN823*
S50PN823 / S70PN823
S50PN823D / S70PN823D



RHINESTONE
S70PN824

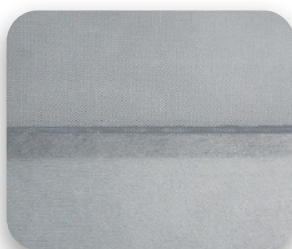

DUSTY BLUE
S70PN821



ROYAL BLUE
S70PN029D

AVAILABLE COLORS *SOLID TONES*

50mm = 2" VANES | 65mm = 2.5" VANES | 70mm = 3" VANES

D = ROOM DARKENING VANE - COLOR SUFFIX
KN = WOVEN SHEER VANE (★)



EGGSHELL
S70PN111D



GREEK VILLA
S70PN114D



BARCELONA BEIGE
S70PN312D



NATURAL TAN
S70PN321D



KHAKI
S70PN303D



BISCUIT
S50PN145D / S70PN145D



CORN SILK
S50PN414D / S70PN414D



LAZY GRAY
S70PN822D



MIDNIGHT
S70PN016D

CONTINUOUS CORD LOOP (CCL) SHEERVIEW SHADE

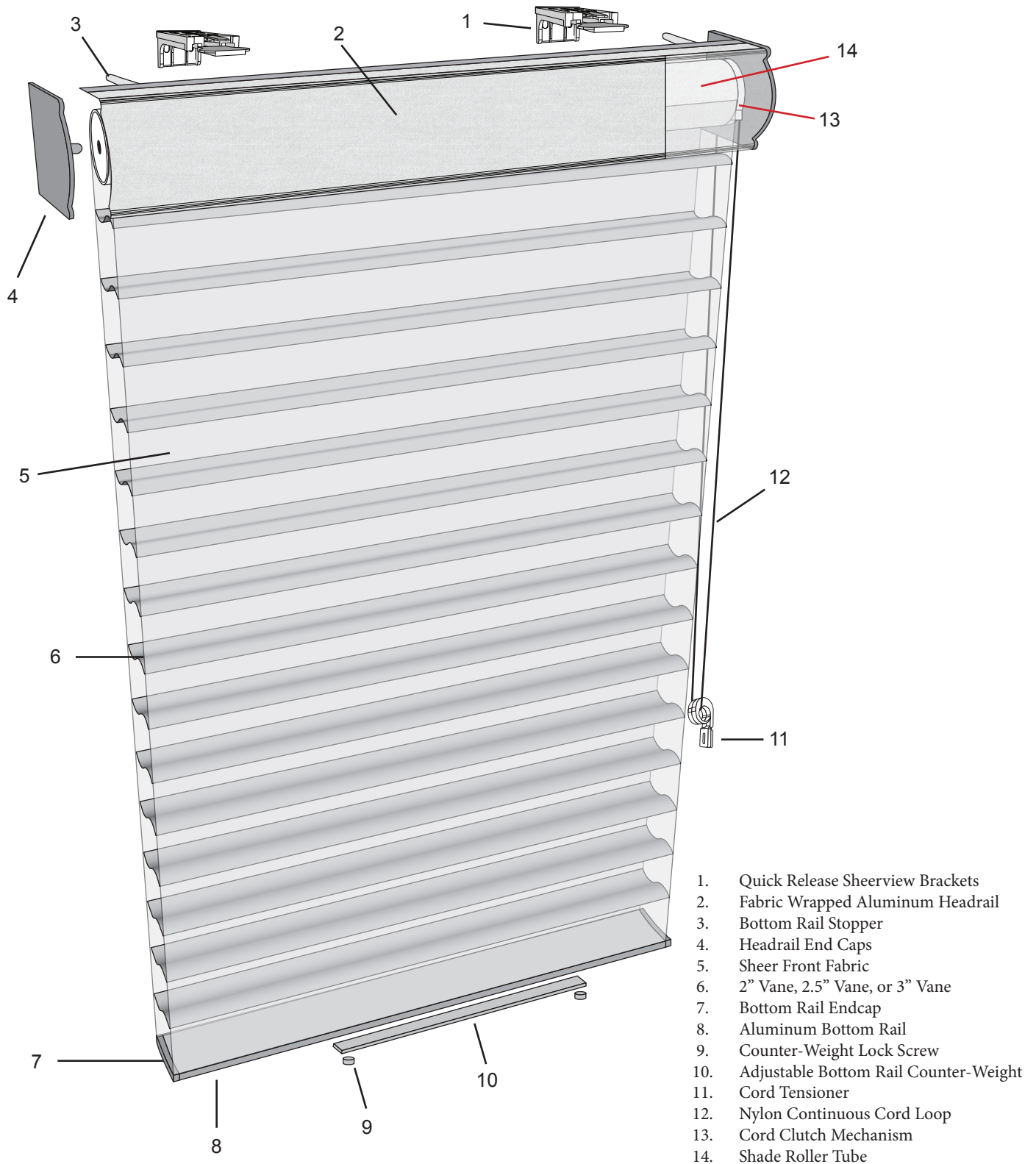

CORDLESS SHEERVIEW SHADE

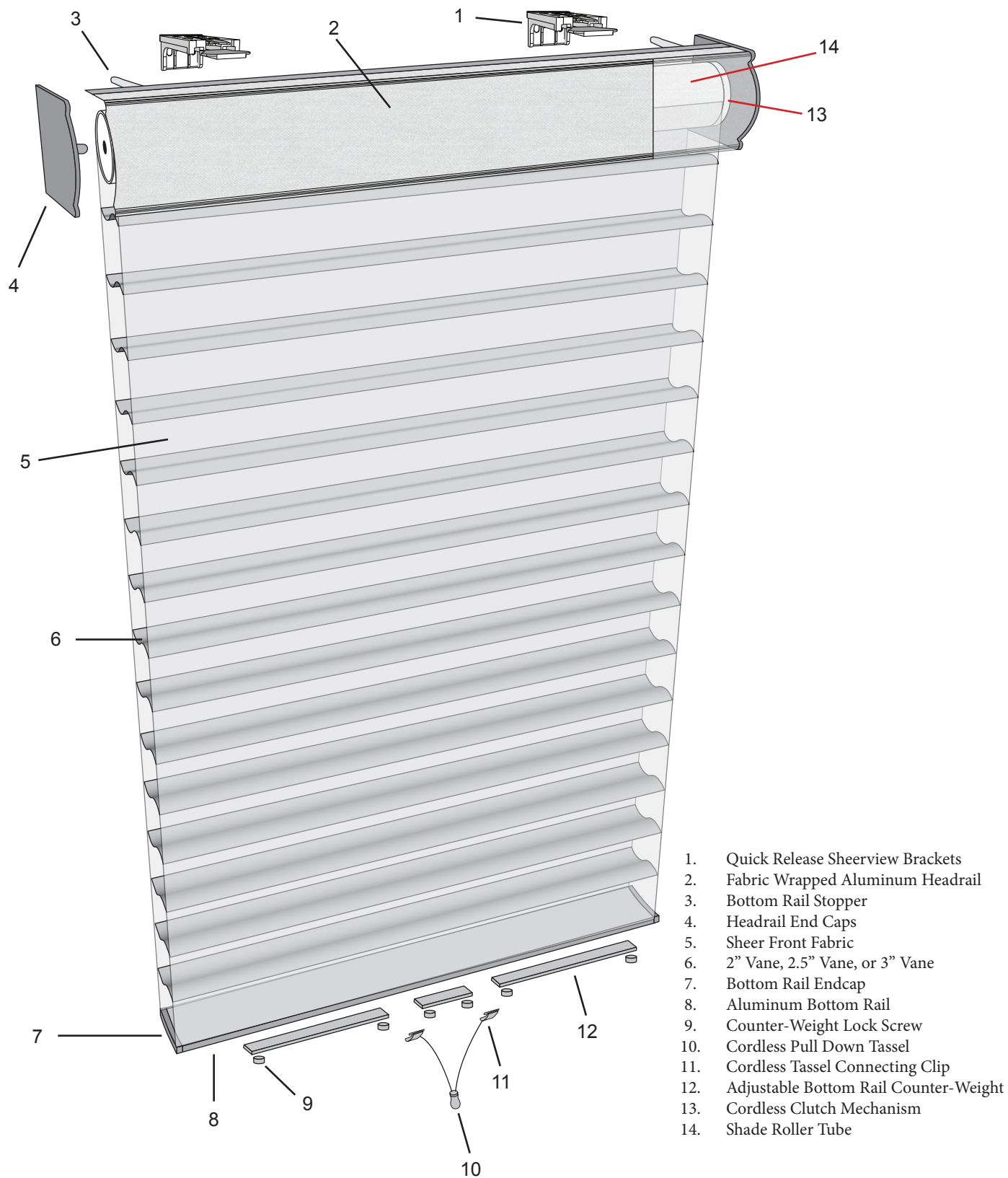

MOTORIZED SHEERVIEW SHADE

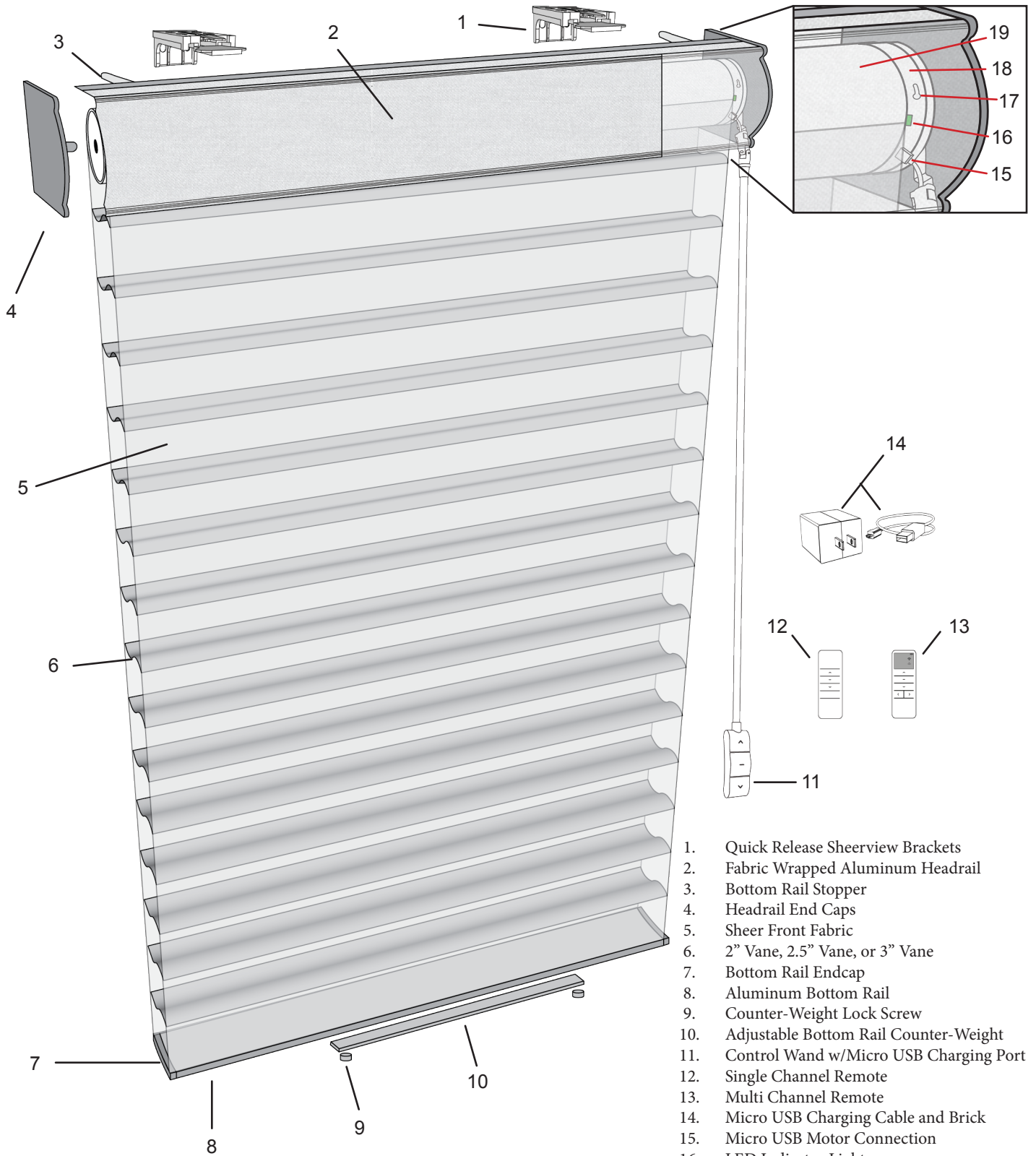

1. Quick Release Sheerview Brackets
2. Fabric Wrapped Aluminum Headrail
3. Bottom Rail Stopper
4. Headrail End Caps
5. Sheer Front Fabric
6. 2" Vane, 2.5" Vane, or 3" Vane
7. Bottom Rail Endcap
8. Aluminum Bottom Rail
9. Counter-Weight Lock Screw
10. Adjustable Bottom Rail Counter-Weight
11. Control Wand w/Micro USB Charging Port
12. Single Channel Remote
13. Multi Channel Remote
14. Micro USB Charging Cable and Brick
15. Micro USB Motor Connection
16. LED Indicator Light
17. Motor Reset Button
18. Electric Motor and Rechargeable Battery
19. Shade Roller Tube

HEADRAIL AND BOTTOM-RAIL DETAILS

Shade comes standard with the headrail wrapped in a color matching material, unless otherwise specified.

Fabric Covered Headrail

Cord-Loop Tensioner

The continuous cord-loop enables ease of use of the Sheerview Shade. The Window Covering Safety Council (WCSC) suggests that the Cord Tensioner device be permanently anchored to the window jamb, wall or floor.

Registered Trademark (®)

Cord-Loop Tensioner

Brackets

Easy to install One Clip Brackets, come with shims to even the shade if the window jamb is uneven.

Stoppers

Prevents the bottom-rail from looping up into the headrail when raised up, or with motorization.



Bottom-Rail

PATENT PENDING

Bottom-Rail features an improved design that enables you to experience less light gap when the Sheerview Shade is in the lowered/closed position.



Adjustable counter weight keeps sheer shade level.

MOTORIZED WAND / REMOTE CONTROL



TECHNOLOGY THAT ENHANCES THE LIVING SPACE

AVAILABLE IN TWO MOTOR OPTIONS

OPTION 1: RECHARGEABLE MOTOR WITH WAND CONTROL

OPTION 2: RECHARGEABLE MOTOR WITH RADIO REMOTE CHIP AND WAND CONTROL

- Easy Installation with no Hard Wiring
- Long Lasting Lithium Ion Battery
- Simple UP/DOWN/STOP Control Buttons
- Micro USB for Charging the Battery

WANDS	MSRP COST
Replacement Wand	\$166
CHARGING BRICK / USB CABLE	
Charging Brick	\$28
Micro USB Cable - 6'	\$34



REMOTE CONTROL - OPTIONAL

(MUST ORDER MOTOR WITH RADIO REMOTE CHIP)

- Radio Remote
- Control your Product with a Single Channel or Multi-Channel Remote from up to 100 Feet *up to 20 shades per channel.*
- Remote Attaches to the Backplate Via Magnets, Just Attach the Backplate in a Convenient Place
- No Pull Cords Means This is the Best Product for Child and Pet Safety
- Modern and Sleek Design Fits All Types of Decor

REMOTE	MSRP COST
Single Channel	\$120
Multi-Channel	\$150



Multi-Channel



Single Channel

CHILD SAFETY INFORMATION

The Manufacturer Is Committed to Child Safety regarding Window Coverings.

The Manufacturer has committed to join the Window Covering Manufacturers Association's new safety standards in the efforts to prevent accidents involving children and pets involving accessible cords and by offering other product options that are child-safe custom window coverings.

"Best For Kids" Certified Program

Window Covering Manufacturers Association (WCMA) announced the industry's first third-party certification program designed to help consumers and retailers identify window covering products that are best suited for use in homes with young children.

To be part of the new Best for Kids program, products are submitted to a WCMA-recognized third party testing laboratory where the products are required to and must meet stringent criteria. Once the products meet these criteria, they are "Certified Best For Kids". The Manufacturer has a number of products "Certified Best For Kids".



Child Safety Is Serious Business.

That's why the window coverings industry uses warning tags, warning labels, and other methods to communicate the potential hazards of corded window coverings. The warning label shown below, for example, communicates the important message about cords being a potential strangulation hazard and suggests choosing cordless alternatives or products with inaccessible cords. Blinds and shades that are improperly installed or out of safety compliance can pose a potential strangulation hazard to young children. According to the U.S. Consumer Product Safety Commission, corded window coverings are among the top hidden hazards in American homes.

The Manufacturer Is Committed to Child Safety regarding Window Coverings.



Window Blind Cord Can STRANGLE Your Child.

Keep cords out of children's reach. Shorten cords to prevent reach.
Move crib and furniture away - Children can climb furniture to reach cords.

La cuerda de la persiana puede ESTRANGULAR a su niño.

Mantenga las cuerdas fuera del alcance de los niños. Acorte las cuerdas para evitar el alcance.
Mueva la cuna y los muebles - Los niños pueden subir los muebles para alcanzar las cuerdas.

To learn more about the Window Covering Safety Council's efforts to protect children from potential cord hazards, visit their site at <https://windowcoverings.org>.

LIGHT FILTERING

SUGGESTED RETAIL PRICE

NOTE: Cord lengths are based on standards. You have the option of choosing a longer cord.

2.5" Sheer Shade - NON WOVEN | PRINTED

Smallest width available 7.5" exact a manual shade
Smallest width available 24" exact for Motorized E-Series shade

	Height Up To	Width Up To													Loop Cord Length
		24"	32"	36"	42"	48"	54"	60"	66"	72"	84"	96"	108"	116"	
	36"	480	535	591	645	701	758	811	870	1006	1121	1235	1358	1561	12"
	42"	503	563	621	686	743	809	870	930	1070	1194	1317	1449	1665	12"
	48"	532	591	658	722	790	857	929	996	1140	1269	1406	1546	1778	18"
	54"	550	620	691	764	838	910	987	1065	1207	1346	1499	1649	1896	18"
	60"	572	653	728	804	878	961	1044	1127	1265	1430	1594	1754	2017	24"
	66"	596	679	763	844	930	1017	1111	1196	1334	1517	1696	1866	2145	24"
	72"	621	709	797	885	978	1074	1173	1265	1406	1596	1791	1970	2265	24"
	78"	635	733	826	920	1018	1120	1221	1325	1469	1676	1877	2065	2374	30"
	84"	662	763	858	966	1071	1176	1290	1394	1544	1766	1977	2175	2501	30"
	90"	689	790	895	1008	1119	1238	1347	1463	1616	1849	2076	2283	2626	36"
	96"	713	824	933	1050	1173	1290	1412	1529	1691	1935	2172	2389	2748	36"
	102"	809	930	1053	1183	1305	1422	1581	1737	1853	2099	2338	2573	2959	36"
	108"	850	976	1105	1244	1369	1495	1662	1822	1945	2205	2460	2706	3112	42"
	114"	900	1035	1170	1317	1457	1588	1761	1935	2065	2338	2609	2870	3299	42"
	120"	961	1103	1255	1408	1550	1696	1881	2065	2206	2502	2787	3066	3526	48"
	132"	1105	1268	1443	1619	1783	1951	2162	2374	2538	2877	3205	3526	4055	48"
	144"	1270	1458	1660	1862	2050	2243	2488	2731	2918	3308	3686	4054	4663	54"

Shades greater than 96" wide
incur an additional Net \$94.00
charge per box for each order.

Systems Upgrade Retail Surcharges

	Min-Width	Max-Width	Max-Height
Cordless system: \$100	20 inches	84 inches	84 inches
Motorization includes Wand: \$270	24 inches	116 inches	144 inches
Motorization using Remote: \$500			
Single Channel Radio Remote Control: \$120			
Multi-Channels Radio Remote Control: \$150			
USB 6' Cable with Charger: \$62			

NOTES

Smallest width available 7.5" exact for a manual Sheerview Shade. Smallest width available 24" exact for Motorized E-Series Sheerview Shade. Fabric Wrapped Headrail comes standard unless asked otherwise.

Shades greater than 96" incur an additional Net \$94.00 charge per box for each order.

LIGHT FILTERING

SUGGESTED RETAIL PRICE

NOTE: Cord lengths are based on standards. You have the option of choosing a longer cord.

2" Sheer Shade - NON WOVEN | SOLID

Smallest width available 7.5" exact a manual shade
Smallest width available 24" exact for Motorized E-Series shade

	Height Up To	Width Up To													Loop Cord Length
		24"	32"	36"	42"	48"	54"	60"	66"	72"	84"	96"	108"	116"	
	36"	417	465	514	561	610	659	705	756	875	976	1073	1180	1358	12"
	42"	438	489	540	596	646	703	756	809	930	1038	1145	1259	1448	12"
	48"	463	514	572	628	687	745	808	867	991	1103	1222	1345	1546	18"
	54"	478	539	600	664	729	792	857	926	1050	1171	1303	1434	1649	18"
	60"	499	567	632	699	764	836	908	980	1100	1243	1387	1526	1754	24"
	66"	518	591	663	734	809	884	965	1040	1161	1319	1474	1622	1866	24"
	72"	540	617	693	769	851	934	1020	1100	1222	1389	1557	1713	1970	24"
	78"	552	637	719	800	885	975	1061	1151	1278	1457	1632	1795	2064	30"
	84"	577	663	746	840	931	1023	1122	1212	1343	1535	1719	1891	2174	30"
	90"	599	687	778	876	973	1076	1172	1272	1405	1608	1805	1986	2283	36"
	96"	620	717	811	913	1020	1122	1227	1329	1470	1682	1889	2078	2389	36"
	102"	703	809	916	1029	1135	1237	1375	1510	1611	1825	2033	2237	2572	36"
	108"	738	849	961	1082	1190	1299	1445	1585	1692	1917	2139	2353	2706	42"
	114"	782	899	1018	1145	1268	1381	1532	1682	1795	2033	2268	2495	2869	42"
	120"	836	959	1091	1224	1348	1474	1636	1795	1919	2175	2424	2666	3066	48"
	132"	961	1103	1255	1408	1550	1696	1881	2065	2206	2502	2787	3066	3526	48"
	144"	1105	1268	1443	1619	1783	1951	2162	2374	2538	2877	3205	3526	4055	54"

Shades greater than 96" wide
incur an additional Net 94.00
charge per box for each order.

Systems Upgrade Retail Surcharges

	Min-Width	Max-Width	Max-Height
Cordless system: \$100	20 inches	84 inches	84 inches
Motorization includes Wand: \$270	24 inches	116 inches	144 inches
Motorization using Remote: \$500			
Single Channel Radio Remote Control: \$120			
Multi-Channels Radio Remote Control: \$150			
USB 6' Cable with Charger: \$62			

NOTES

Smallest width available 7.5" exact for a manual Sheerview Shade. Smallest width available 24" exact for Motorized E-Series Sheerview Shade. Fabric Wrapped Headrail comes standard unless asked otherwise.

Shades greater than 96" incur an additional Net \$94.00 charge per box for each order.

LIGHT FILTERING

SUGGESTED RETAIL PRICE

NOTE: Cord lengths are based on standards. You have the option of choosing a longer cord.

3" Sheer Shade - NON WOVEN | SOLID

Smallest width available 7.5" exact a manual shade
Smallest width available 24" exact for Motorized E-Series shade

	Height Up To	Width Up To													Loop Cord Length
		24"	32"	36"	42"	48"	54"	60"	66"	72"	84"	96"	108"	116"	
	36"	471	522	578	630	686	742	794	851	984	1097	1207	1328	1527	12"
	42"	491	551	608	670	728	791	851	910	1048	1168	1288	1418	1630	12"
	48"	521	579	644	706	773	839	908	975	1115	1241	1374	1512	1738	18"
	54"	538	607	675	748	819	889	964	1041	1180	1316	1467	1614	1856	18"
	60"	561	639	710	785	858	939	1022	1102	1237	1398	1560	1717	1974	24"
	66"	582	664	747	827	910	995	1087	1171	1305	1483	1659	1825	2098	24"
	72"	608	694	779	866	958	1052	1146	1237	1374	1563	1752	1926	2215	24"
	78"	621	718	809	899	996	1097	1195	1295	1437	1640	1836	2020	2322	30"
	84"	649	747	839	945	1048	1150	1262	1364	1510	1727	1935	2128	2447	30"
	90"	674	773	875	987	1096	1211	1318	1432	1581	1809	2030	2233	2568	36"
	96"	697	806	913	1027	1146	1263	1381	1496	1654	1893	2126	2339	2689	36"
	102"	791	911	1030	1159	1278	1391	1547	1698	1812	2053	2287	2516	2893	36"
	108"	830	956	1081	1217	1339	1463	1625	1783	1904	2158	2405	2646	3043	42"
	114"	880	1012	1145	1288	1425	1553	1724	1891	2019	2287	2551	2807	3227	42"
	120"	941	1077	1226	1378	1516	1659	1840	2019	2158	2447	2726	2999	3450	48"
	132"	1081	1239	1410	1585	1744	1908	2116	2322	2481	2814	3135	3449	3966	48"
	144"	1243	1425	1622	1822	2005	2194	2434	2671	2854	3236	3606	3965	4562	54"

Shades greater than 96" wide incur an additional Net \$94.00 charge per box for each order.

Systems Upgrade Retail Surcharges

	Min-Width	Max-Width	Max-Height
Cordless system: \$100	20 inches	84 inches	84 inches
Motorization includes Wand: \$270	24 inches	116 inches	144 inches
Motorization using Remote: \$500			
Single Channel Radio Remote Control: \$120			
Multi-Channels Radio Remote Control: \$150			
USB 6' Cable with Charger: \$62			

NOTES

Smallest width available 7.5" exact for a manual Sheerview Shade. Smallest width available 24" exact for Motorized E-Series Sheerview Shade. Fabric Wrapped Headrail comes standard unless asked otherwise.

Shades greater than 96" incur an additional Net \$94.00 charge per box for each order.

LIGHT FILTERING

SUGGESTED RETAIL PRICE

NOTE: Cord lengths are based on standards. You have the option of choosing a longer cord.

2" Sheer Shade - WOVEN | SOLID

Smallest width available 7.5" exact a manual shade
Smallest width available 24" exact for Motorized E-Series shade

	Height Up To	Width Up To													Loop Cord Length
		24"	32"	36"	42"	48"	54"	60"	66"	72"	84"	96"	108"	116"	
	36"	439	489	539	589	641	692	740	794	919	1025	1127	1239	1425	12"
	42"	459	514	567	626	678	738	794	850	976	1090	1203	1323	1520	12"
	48"	487	539	601	659	721	782	849	911	1040	1159	1283	1412	1623	18"
	54"	502	566	630	698	765	831	900	972	1102	1229	1369	1505	1731	18"
	60"	523	596	664	734	803	877	953	1029	1155	1305	1456	1602	1841	24"
	66"	544	621	697	770	850	928	1013	1092	1219	1386	1548	1703	1959	24"
	72"	567	648	728	808	893	981	1071	1155	1283	1458	1635	1799	2068	24"
	78"	580	669	755	840	929	1024	1115	1209	1342	1530	1713	1885	2167	30"
	84"	606	697	783	882	978	1074	1178	1273	1410	1612	1805	1985	2283	30"
	90"	629	721	816	920	1021	1130	1231	1335	1476	1688	1895	2085	2398	36"
	96"	651	753	852	959	1071	1178	1288	1395	1544	1767	1983	2182	2509	36"
	102"	738	850	962	1081	1192	1299	1443	1586	1692	1916	2135	2350	2701	36"
	108"	776	891	1009	1136	1250	1364	1517	1664	1776	2014	2246	2471	2841	42"
	114"	822	944	1069	1203	1331	1451	1609	1767	1885	2135	2382	2620	3012	42"
	120"	877	1007	1146	1285	1416	1548	1717	1885	2015	2284	2544	2800	3219	48"
	132"	1009	1159	1318	1479	1627	1780	1975	2169	2317	2627	2926	3219	3702	48"
	144"	1161	1331	1515	1700	1871	2048	2271	2493	2665	3021	3365	3702	4259	54"

Shades greater than 96" wide incur an additional Net \$94.00 charge per box for each order.

Systems Upgrade Retail Surcharges

	Min-Width	Max-Width	Max-Height
Cordless system: \$100	20 inches	84 inches	84 inches
Motorization includes Wand: \$270	24 inches	116 inches	144 inches
Motorization using Remote: \$500			
Single Channel Radio Remote Control: \$120			
Multi-Channels Radio Remote Control: \$150			
USB 6' Cable with Charger: \$62			

NOTES

Smallest width available 7.5" exact for a manual Sheerview Shade. Smallest width available 24" exact for Motorized E-Series Sheerview Shade. Fabric Wrapped Headrail comes standard unless asked otherwise.

Shades greater than 96" incur an additional Net \$94.00 charge per box for each order.

LIGHT FILTERING

SUGGESTED RETAIL PRICE

NOTE: Cord lengths are based on standards. You have the option of choosing a longer cord.

3" Sheer Shade - WOVEN | SOLID

Smallest width available 7.5" exact a manual shade
Smallest width available 24" exact for Motorized E-Series shade

	Height Up To	Width Up To													Loop Cord Length
		24"	32"	36"	42"	48"	54"	60"	66"	72"	84"	96"	108"	116"	
	36"	494	548	607	661	720	779	834	893	1034	1151	1267	1394	1603	12"
	42"	516	579	638	703	764	830	893	956	1100	1227	1352	1488	1711	12"
	48"	547	608	676	742	811	881	953	1024	1171	1303	1442	1588	1824	18"
	54"	565	637	709	785	859	934	1012	1094	1239	1382	1541	1694	1950	18"
	60"	589	671	746	825	901	987	1073	1158	1299	1468	1638	1803	2073	24"
	66"	611	698	784	869	956	1045	1142	1229	1371	1557	1742	1916	2203	24"
	72"	638	729	817	908	1006	1104	1204	1299	1442	1641	1839	2022	2326	24"
	78"	652	754	850	944	1046	1151	1255	1360	1509	1723	1928	2121	2439	30"
	84"	682	784	881	992	1100	1208	1325	1433	1586	1814	2031	2234	2569	30"
	90"	708	811	919	1036	1150	1272	1385	1503	1661	1900	2131	2344	2696	36"
	96"	732	846	959	1079	1204	1326	1451	1571	1737	1987	2232	2456	2824	36"
	102"	830	957	1082	1217	1342	1461	1624	1783	1902	2156	2401	2642	3038	36"
	108"	872	1004	1135	1278	1406	1535	1707	1871	1999	2266	2525	2779	3195	42"
	114"	923	1063	1203	1352	1497	1631	1810	1985	2120	2401	2678	2947	3389	42"
	120"	988	1131	1287	1447	1592	1742	1932	2120	2266	2569	2862	3149	3622	48"
	132"	1135	1301	1481	1664	1832	2003	2222	2439	2605	2955	3292	3621	4164	48"
	144"	1305	1497	1703	1913	2106	2304	2556	2804	2996	3397	3787	4163	4790	54"

Shades greater than 96" wide
incur an additional Net 94.00
charge per box for each order.

Systems Upgrade Retail Surcharges

	Min-Width	Max-Width	Max-Height
Cordless system: \$100	20 inches	84 inches	84 inches
Motorization includes Wand: \$270	24 inches	116 inches	144 inches
Motorization using Remote: \$500			
Single Channel Radio Remote Control: \$120			
Multi-Channels Radio Remote Control: \$150			
USB 6' Cable with Charger: \$62			

NOTES

Smallest width available 7.5" exact for a manual Sheerview Shade. Smallest width available 24" exact for Motorized E-Series Sheerview Shade. Fabric Wrapped Headrail comes standard unless asked otherwise.

Shades greater than 96" incur an additional Net \$94.00 charge per box for each order.

ROOM DARKENING

SUGGESTED RETAIL PRICE

NOTE: Cord lengths are based on standards. You have the option of choosing a longer cord.

2" Sheer Shade - NON WOVEN | SOLID

Smallest width available 7.5" exact a manual shade
Smallest width available 24" exact for Motorized E-Series shade

	Height Up To	Width Up To													Loop Cord Length
		24"	32"	36"	42"	48"	54"	60"	66"	72"	84"	96"	108"	116"	
	36"	460	511	565	617	670	725	776	832	962	1073	1180	1299	1494	12"
	42"	482	538	594	656	710	774	832	889	1023	1142	1259	1386	1593	12"
	48"	509	565	629	691	755	820	888	953	1090	1213	1345	1479	1700	18"
	54"	525	593	661	731	801	871	944	1019	1153	1287	1434	1577	1814	18"
	60"	548	625	696	768	840	919	998	1077	1210	1367	1526	1678	1930	24"
	66"	570	651	730	808	889	972	1063	1144	1277	1452	1622	1785	2052	24"
	72"	594	678	763	846	935	1028	1122	1210	1345	1528	1713	1884	2167	24"
	78"	608	701	791	881	973	1071	1167	1268	1405	1603	1795	1975	2272	30"
	84"	633	730	821	923	1025	1126	1235	1333	1477	1688	1891	2081	2393	30"
	90"	659	755	856	964	1070	1184	1288	1398	1546	1769	1986	2184	2511	36"
	96"	682	788	892	1004	1122	1235	1350	1463	1617	1850	2078	2286	2629	36"
	102"	774	889	1007	1132	1249	1360	1513	1661	1772	2008	2237	2460	2829	36"
	108"	812	933	1057	1190	1310	1430	1589	1743	1862	2109	2353	2588	2977	42"
	114"	860	990	1118	1259	1394	1518	1685	1850	1975	2237	2495	2745	3157	42"
	120"	836	1055	1201	1347	1482	1622	1799	1975	2110	2393	2666	2933	3373	48"
	132"	961	1213	1380	1548	1705	1866	2068	2272	2427	2752	3066	3373	3879	48"
	144"	1105	1395	1587	1782	1960	2145	2379	2612	2792	3164	3526	3879	4460	54"

Shades greater than 96" wide
incur an additional Net \$94.00
charge per box for each order.

Systems Upgrade Retail Surcharges

	Min-Width	Max-Width	Max-Height
Cordless system: \$100	20 inches	84 inches	84 inches
Motorization includes Wand: \$270	24 inches	116 inches	144 inches
Motorization using Remote: \$500			
Single Channel Radio Remote Control: \$120			
Multi-Channels Radio Remote Control: \$150			
USB 6' Cable with Charger: \$62			

NOTES

Smallest width available 7.5" exact for a manual Sheerview Shade. Smallest width available 24" exact for Motorized E-Series Sheerview Shade. Fabric Wrapped Headrail comes standard unless asked otherwise.

Shades greater than 96" incur an additional Net \$94.00 charge per box for each order.

ROOM DARKENING

SUGGESTED RETAIL PRICE

NOTE: Cord lengths are based on standards. You have the option of choosing a longer cord.

3" Sheer Shade - NON WOVEN | SOLID

Smallest width available 7.5" exact a manual shade
Smallest width available 24" exact for Motorized E-Series shade

	Height Up To	Width Up To													Loop Cord Length
		24"	32"	36"	42"	48"	54"	60"	66"	72"	84"	96"	108"	116"	
	36"	518	575	635	693	754	815	873	935	1082	1207	1328	1461	1680	12"
	42"	541	607	668	737	800	870	935	1000	1151	1285	1418	1558	1793	12"
	48"	574	637	707	777	850	922	998	1071	1226	1365	1512	1663	1912	18"
	54"	592	667	743	823	901	979	1061	1146	1298	1447	1614	1775	2042	18"
	60"	617	703	782	865	945	1033	1125	1212	1360	1539	1717	1887	2171	24"
	66"	640	731	822	910	1000	1095	1196	1287	1435	1632	1825	2007	2308	24"
	72"	668	764	857	952	1054	1156	1260	1360	1512	1719	1926	2120	2436	24"
	78"	683	789	889	990	1096	1207	1314	1425	1580	1804	2020	2221	2555	30"
	84"	714	822	922	1039	1151	1265	1389	1501	1661	1900	2128	2341	2691	30"
	90"	742	850	962	1086	1205	1332	1450	1575	1740	1990	2233	2457	2825	36"
	96"	766	886	1004	1130	1260	1390	1518	1646	1820	2082	2339	2572	2959	36"
	102"	870	1002	1134	1274	1405	1530	1701	1868	1992	2258	2516	2767	3182	36"
	108"	913	1052	1189	1338	1473	1609	1789	1960	2094	2374	2646	2910	3348	42"
	114"	967	1113	1259	1418	1568	1709	1896	2081	2220	2516	2807	3087	3550	42"
	120"	1034	1186	1349	1515	1668	1825	2024	2220	2374	2691	2999	3300	3794	48"
	132"	1189	1364	1552	1743	1919	2099	2328	2554	2730	3096	3449	3794	4363	48"
	144"	1367	1569	1784	2004	2206	2414	2677	2937	3139	3559	3965	4363	5018	54"

Shades greater than 96" wide
incur an additional Net \$94.00
charge per box for each order.

Systems Upgrade Retail Surcharges

	Min-Width	Max-Width	Max-Height
Cordless system: \$100	20 inches	84 inches	84 inches
Motorization includes Wand: \$270	24 inches	116 inches	144 inches
Motorization using Remote: \$500			
Single Channel Radio Remote Control: \$120			
Multi-Channels Radio Remote Control: \$150			
USB 6' Cable with Charger: \$62			

NOTES

Smallest width available 7.5" exact for a manual Sheerview Shade. Smallest width available 24" exact for Motorized E-Series Sheerview Shade. Fabric Wrapped Headrail comes standard unless asked otherwise.

Shades greater than 96" incur an additional Net \$94.00 charge per box for each order.

MEASURING

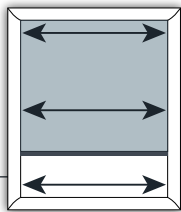

Inside Mount Width (IB)

- Measure the exact width of the inside edge of the window frame. - Top, Middle, and Bottom.
- Make all measurements to the nearest 1/8th inch, round DOWN for width.
- Take the SMALLEST of the 3 measurements, this is the width that you will order.
- Production department will make the necessary deductions to ensure the shade fits inside your window.

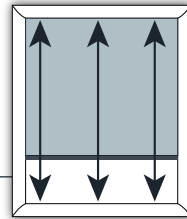

Inside Mount Height (IB)

- Measure the exact height from the top inside edge down to the window sill in 3 places. – Left, Middle, Right
- Make all measurements to the nearest 1/8th inch, round UP for height.
- Take the LARGEST of the 3 measurements, this is the height that you will order.

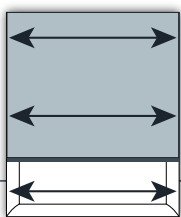

Outside Mount Width (OB)

- Measure the exact width of the window frame or how wide you would like the shade to be.
- Be sure to measure wide enough to cover the entire window (and trim if desired) to provide maximum light coverage.
- Example: If the window opening is 36" wide, it might be helpful to order 40" if the space allows. This will provide 2" coverage on each side of the window.
- No deductions/additions will be made to the width ordered.

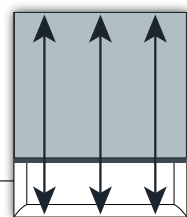

Outside Mount Height (OB)

- Measure the height you would like the shade to be by measuring top to bottom.
- Be sure to measure high enough to cover the entire window (and trim if desired) to provide maximum light coverage.
- Example: If the window opening is 60" high, it might be helpful to order 64" if the space allows. This will provide 2" coverage on top and bottom of the window.
- No deductions/additions will be made to the height ordered.

Cleaning and Care Information

Sheerview Shades are virtually maintenance free. Only periodic vacuuming on a low setting and an occasional feather dusting is needed. The sheer fabric may also be ultrasonically cleaned.

MEASURING

Finished Dimensions:

- Once ordered and manufactured, the width of the fabric cannot be altered. The Manufacturer makes deductions to the width of window shadings depending on the type of mounting indicated. For all mounting types, the fabric will measure exactly the length ordered when the vanes are in the open or “view-through” position. When the vanes are rotated to the closed position, the shading will become 3/8” longer.

Measurement Considerations:

- When closed on an inside mount, a slight furrow may occur on the lowermost sheer section because of contact with the sill. To compensate, slightly raise the shading until the rail begins to lift off the window sill.
- If preferred, the shading can be ordered 3/8” less than the measured height of the window opening. In this case, the bottom rail will be positioned 3/8” above the sill when the vanes are in the open position. Rotating the vanes closed will cause the bottom rail to touch the window sill and thus closing any unwanted space.

Headrail Information:

- The Sheerview comes with a standard headrail wrapped in a *color coordinated fabric with an option of color coordinated aluminum. *Unless otherwise specified.
- *Headrail will measure ordered width minus: 1/8”
- (IB) Fabric will measure ordered width minus: 15/16” (OB) Fabric will measure ordered width minus: 13/16”

Inside Mount

Minimum depth for flush inside mount including installation brackets: 3 1/4”

Outside Mount

Minimum surface area required for mounting: 3/4”

Cord Information:

- Braided polyester cord styles will measure the height indicated below unless otherwise specified.
- Maximum Cord Heights: Polyester Cord - 15 ft.
- Cord can be ordered in custom lengths in one foot increments only.

To see standard cord lengths please see the pricing charts on pages 10 - 16.

NOTE:

- Customer can specify custom cord length.
- Following the WCMA National Safety Standards, all cords will be made 40% of the length of the shade unless otherwise specified.

PRODUCT SPECIFICATIONS AND OPERATION

Shading Operation:

- The Sheerview Horizontal Sheer Shade features the Continuous Cord-Loop System. This system provides the ability to manipulate the shading into various viewing positions. From the closed and retracted position (fabric inside the headrail), lower the fabric by pulling down on the rear of the cord until you reach the desired shading position. Once lowered completely to the window sill, continuing to pull the cord in the same direction will open the horizontal fabric vanes, offering varied views to the outside. To retract the shading, pull down on the front of the cord until the shading reaches the desired viewing mode or fabric position. Shade will not tilt open unless fully lowered.

Hardware:

- **Installation Headrail Brackets**
Multi-faceted bracket system includes breakaway shims to assist in leveling. The bracket also includes easy release lever.
- **Spacer Blocks** - *Upon Request Only*
Spacer blocks project the shading 3/8" from the mounting surface. Use spacer blocks to obtain clearance when obstructions, such as window cranks or door handles, obstruct the movement of shading.
- **Hold Down Brackets** - *Upon Request Only*
Hold down brackets are made of clear plastic that fit into holes on the end-cap of the bottom rail. Hold downs are generally used to secure the base of the window shading to prevent swaying.
- **Cord Tensioner**
The cord tensioner keeps the cord taut to prevent children and pets from entangling and subsequently injuring themselves. Cord tensioner must be used for this product to comply with the Consumer Product Safety Commission (CPSC) Child Safety Guidelines.

Skew Adjusting Bottom Rail:

- The Sheerview Horizontal Sheer Shades are leveled and weighed in the factory. When installed level, the fabric will not skew when raised. If the headrail is not installed level, skewing can occur that can damage the edge of the fabric. Be sure to follow the instructions below carefully to ensure correct and balanced operation.

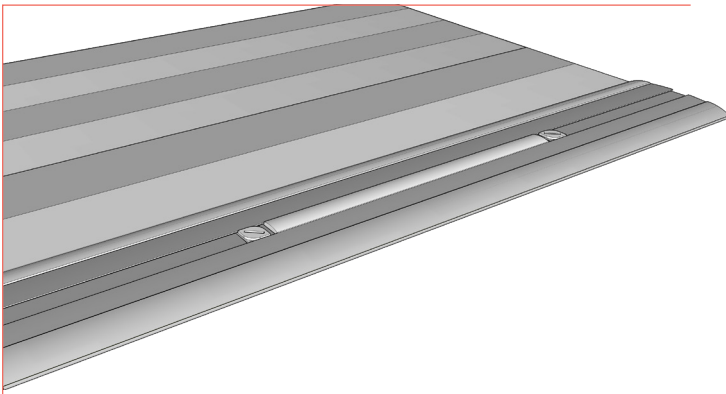

Simply turn over the bottom rail and twist with a flat head screw driver both stoppers on the left and right side of the counterweight slide.

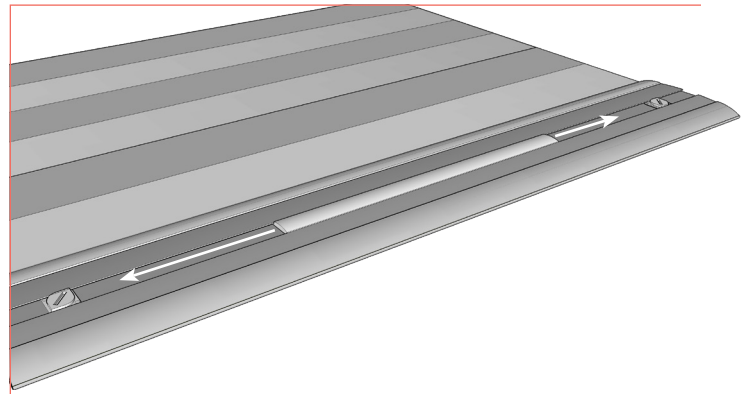

Slide the bar to where the counterweight is needed to combat the shifting of the shades. Twist down with a flat head screw driver on both stoppers in order to once again lock the counterweights.

PROGRAMMING INFORMATION FOR E-SERIES

PLEASE KEEP IN MIND THAT OUR E-SERIES PRODUCTS COME PREPROGRAMMED FROM THE FACTORY SPECIFICALLY FOR YOUR WINDOW HEIGHTS AND TO YOUR MOTOR. THIS INFORMATION SHOULD ONLY BE USED IF THE PROGRAMMING HAS BEEN ACCIDENTALLY ERASED OR AT THE ADVICE OF THE MANUFACTURER. PLEASE UNDERSTAND THAT TECHNICAL SUPPORT IS AT THE DISCRETION OF THE MANUFACTURER IN CASES OF UNAUTHORIZED SYSTEM RESETS.

Pairing A Wireless Remote (only if your motor was ordered with the wireless upgrade)

To pair a wireless remote, press and hold the reset button using a paperclip on the back of the wand for approximately 3 seconds looking for the shade to jog once and beep once.

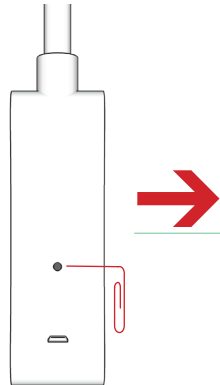

Immediately after the jog and beep press the **up button once** on your wireless remote and the shade will jog once and beep 3 times confirming pairing success. If using a multi-channel remote make sure to have the desired channel selected prior to starting the process.

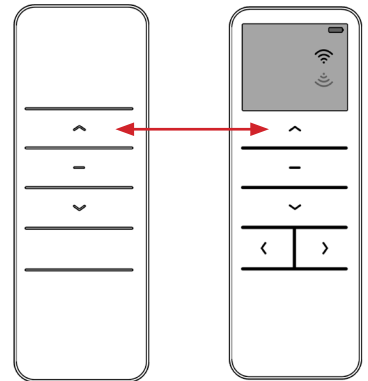

Setting/Adjusting Lift Heights

If the shade has been reset the lift heights have been reset as well. Use the process below to set new lift heights. If an adjustment needs to be made to existing lift heights the process below is the same except you will need to enter "Adjustment Mode". To enter adjustment mode for the top height press and hold the Up and Stop buttons together for 10 seconds looking for a single jog. To enter the adjustment mode for the bottom height press and hold the Down and Stop buttons together for 10 seconds looking for a single jog.

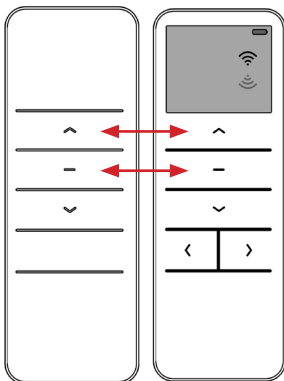

Top Height

Bring the shade to the position at the top nearest to the headrail that you would like to be the top height. You may have to stop the shade manually with the stop button. Press and hold the Up and Stop buttons together for about 3 seconds looking for shade to jog twice and beep once confirming the top height being set. This process can also be performed on the control wand.

Bottom Height

Bring the shade to the position at the bottom nearest to the window sill that you would like to be the bottom height. You may have to stop the shade manually with the stop button. Press and hold the Bottom and Stop buttons together for about 3 seconds looking for shade to jog twice and beep once confirming the bottom height being set. This process can also be performed on the control wand.

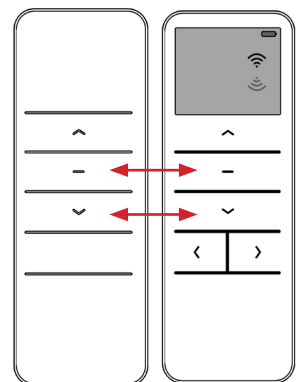

MANUFACTURER TERMS AND CONDITIONS

- Catalog prices (USD) and product specifications are subject to change without notice.
- All materials are subject to dye lot variations
- Manufacturer will not assume responsibility for any color mismatch after subsequent orders
- There is a \$40.00 charge for any returned checks
- For any product the manufacturer performs warranty service on, transportation charges are not included in warranty
- State Tax Exemption Certificates must be provided and on file for tax exempt sales production
- There will be a nominal service charge for changes or cancellations made after production has started
- The manufacturer is not responsible for printing or typographical errors within the catalog, website or other published information
- Manufacturer currently ships with most major carriers
- Following the WCMA National Safety Standards, all cords will be made 40% of the length of the product. The manufacturer suggests all cords to be permanently anchored to keep children and pets safe
- Returns must have an RGA Number and be approved
- Claims for merchandise shortages, damages or discrepancies must be made within 10 days of the receipt of goods
- These Sheerview Shades are custom made and cannot be canceled once the order has been put into



WARRANTY

This Limited Lifetime Warranty program is available to consumers who have purchased blinds and shades by (The Manufacturer). This applies to Fabric Horizontal Blinds, Sheer Shades, Roman Shades, Cellular Shades, Pleated Shades, and painted or stained valances. This warranty is effective February 1st, 2021. Product bought prior to effective date will be subject to warranty in place at time of original purchase.

What the Warranty Covers

The manufactured product is warranted against original defects in materials, workmanship or failure to operate for as long as the **original** purchaser owns the product (unless shorter time periods are provided below) on the conditions that;

- The product was properly installed in a residential or commercial dwelling
- The product was made or assembled exclusively from Lantex USA, LLC. materials and components
- The Manufacturer recommendations were followed regarding limitations and specifications
- The Manufacturer componentry are covered for 5 years
- The Manufacturer motorized components are covered for 2 years

Who is Covered

This warranty extends only the ORIGINAL purchaser of the above stated products.

The Manufacturer obligations to the Consumer are limited to the repair or replacement of parts or products found to be defective. The Manufacturer is not responsible for shipping charges or labor costs, for measuring and taking the product down or for remeasuring or reinstalling the product. Defects in product found on arrival must be reported within 10 days of delivery date confirmed by the shipping company. If not the product will be remade at full cost to the consumer.

If repairs are made under this warranty, the repairs will be made with like or similar parts.

TO RECEIVE WARRANTY SERVICE, PLEASE:

1. Contact our Customer Service department at 1.973.424.0909 and advise them of the nature of the issue. Customer Service will provide you with information as to how to proceed.
2. Please remember, product returned for warranty claims must be accompanied by the original sales receipt as well as written details regarding the nature of the problem, location of the product, etc.
3. All remake requests will need a picture or video supporting the claim before being approved.
4. If your product is returned, please retain a copy of the shipping information for your records.

What the Warranty Does Not Cover

This warranty does not cover conditions or damages caused by abuse, accidents, alterations, misuse, or failure to follow instructions for measurement, installation, use, cleaning, or maintenance. Normal wear and tear, including but not limited to the items or occurrences below, is not covered by the warranty:

- Batteries.
- Unfinished cornices.
- All fabrics can lose original intensity after long exposure to the sun. When left for extended periods in direct sunlight, plastics tend to yellow or crack. Some loss of color intensity or discoloration may occur in plastic materials or wood finishes.
- Colors may vary from lot to lot and may not exactly match samples of previous purchases.
- All cords will eventually wear out.

THE MANUFACTURER CONSIDERS THESE ITEMS OR OCCURRENCES NORMAL WEAR AND TEAR, AND THEY ARE NOT COVERED BY THIS WARRANTY. THIS WARRANTY IS EXCLUSIVE AND IN LIEU OF ALL OTHER WRITTEN OR ORAL WARRANTIES OR OBLIGATIONS AND LIABILITIES. NO PERSON IS AUTHORIZED TO EXTEND OR ALTER THIS WARRANTY. THE MANUFACTURER SHALL HAVE NO LIABILITY WHATSOEVER FOR INCIDENTAL OR CONSEQUENTIAL DAMAGES. SOME STATES DO NOT ALLOW THE EXCLUSION OR LIMITATION OF INCIDENTAL OR CONSEQUENTIAL DAMAGES, SO THIS LIMITATION OR EXCLUSION MAY NOT APPLY TO YOU.

THE IMPORTANCE OF ORDERING CORRECTLY FROM THE MANUFACTURER

Place your order correctly with the manufacturer can decrease the need for remakes, refunds or returns.

Important Ordering Information:

- You must include ACCURATE measurements for the width and height (to the nearest 1/8") of the product
- You must specify IB or OB mounting required of the product
- You must include the color name, and color number
- You must include Position Control - RIGHT or LEFT

Fabric Style & Color Selection:

Woven and Non Woven fabrics come in Light filtering and Room Darkening. Choose from the color available.

Example Color Number: **S50PN100D**

- 2" - **S50**
- 2.5" - **S65**
- 3" - **S70**
- Non Woven - **PN**
- Woven - **KN**
- Printed - **BN**
- Color # - **100**
- Room Darkening - **D**

REMAKES: We understand mistakes happen and typically your per-negotiated Oops discount may apply.

REFUNDS: Refunds may be issued at the manufactures discretion.

RETURNS: Dealer must contact the manufacturer directly to obtain and return authorization.

To Find Your Cost:

Height Up To	Width Up To →					
	24"	32"	36"	42"	48"	54"
36"	410	457	504	550	599	647
42"	429	480	530	585	634	690
48"	455	504	562	616	674	731
54"	469	529	589	652	715	777
60"	489	557	624	686	750	820
66"	508	580	651	720	794	867
72"	530	606	680	755	835	917

After finding your price based on fabric size add any additional upgrade surcharges you are purchasing to total price of the shade.



ORDER FORM

NomiStar
102 W Commercial Ave.
Moonachie, New Jersey 07074
973-424-0909

COPY THIS PAGE

ALL INFORMATION RECEIVED WILL BE HANDLED CONFIDENTIALLY.

PLEASE EMAIL TO: info.nj@nomistar.net/info.il@nomistar.net FAX TO: 973-424-9090

BILL TO:	SHIP TO:	SAME AS BILL TO <input type="checkbox"/>
Company: _____	Company: _____	
Street: _____	Street: _____	
City: _____ State: _____ Zip: _____	City: _____ State: _____ Zip: _____	
Country: _____	Country: _____	
Telephone: _____ Fax: _____	Telephone: _____ Fax: _____	

To order an  product please contact Customer Service at info.nj@nomistar.net or call at (973) 424-0909

SHEERVUE

NOTE: IB: The factory will deduct 1/8 - 3/16" off the total width. OB: The factory will make the product to the exact measurements provided.

P.O. NUMBER: _____

SIDE MARK: _____

1	Qty.	IB/OB	Width	Height	2"	2.5"	3"	Color #	Color Name	L/R Cord-Loop
Headrail Option:		Cloth <input type="checkbox"/> Metal <input type="checkbox"/>	Room Name:		Special Note:					
			Window Name:							
2	Qty.	IB/OB	Width	Height	2"	2.5"	3"	Color #	Color Name	L/R Cord-Loop
Headrail Option:		Cloth <input type="checkbox"/> Metal <input type="checkbox"/>	Room Name:		Special Note:					
			Window Name:							
3	Qty.	IB/OB	Width	Height	2"	2.5"	3"	Color #	Color Name	L/R Cord-Loop
Headrail Option:		Cloth <input type="checkbox"/> Metal <input type="checkbox"/>	Room Name:		Special Note:					
			Window Name:							
4	Qty.	IB/OB	Width	Height	2"	2.5"	3"	Color #	Color Name	L/R Cord-Loop
Headrail Option:		Cloth <input type="checkbox"/> Metal <input type="checkbox"/>	Room Name:		Special Note:					
			Window Name:							
5	Qty.	IB/OB	Width	Height	2"	2.5"	3"	Color #	Color Name	L/R Cord-Loop
Headrail Option:		Cloth <input type="checkbox"/> Metal <input type="checkbox"/>	Room Name:		Special Note:					
			Window Name:							

SHEERVUE

HORIZONTAL SHEER SHADE

